

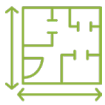

YEAR BUILT  
**1999**



SQUARE FEET  
**5.2 MILLION+**



BUILDING TYPE  
**MIXED-USE:**  
CLASS A OFFICE • HOSPITALITY  
RETAIL • MEDICAL • MULTIFAMILY



CARRIERS

**verizon**✓

**T-Mobile**

**AT&T**

# MEMORIAL CITY

## HOUSTON, TX

Memorial City is a typical Airwavz in-building “end-to-end” operational platform with a C-RAN head end with dedicated fiber optics and D-RAN wireless systems delivering outstanding wireless service across a major development. This solution is building-owner and wireless carrier funded, with radio sources purchased and installed by Airwavz.

Airwavz serves tens of thousands of daily workers and visitors covering more than 5 million square feet of retail, office and hospitality including Memorial City Mall, The Westin Memorial City, Hotel ZaZa Memorial City, and the Memorial Hermann Memorial City Medical Center.

